

Shower Rail

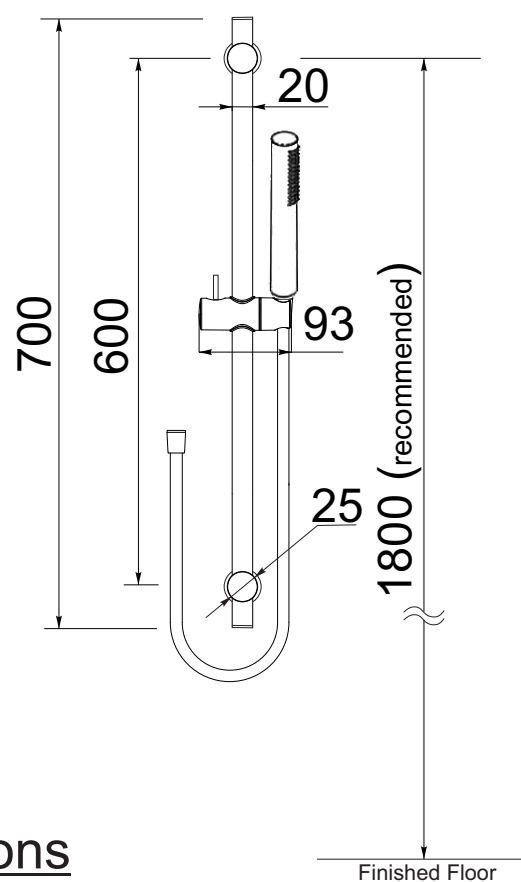
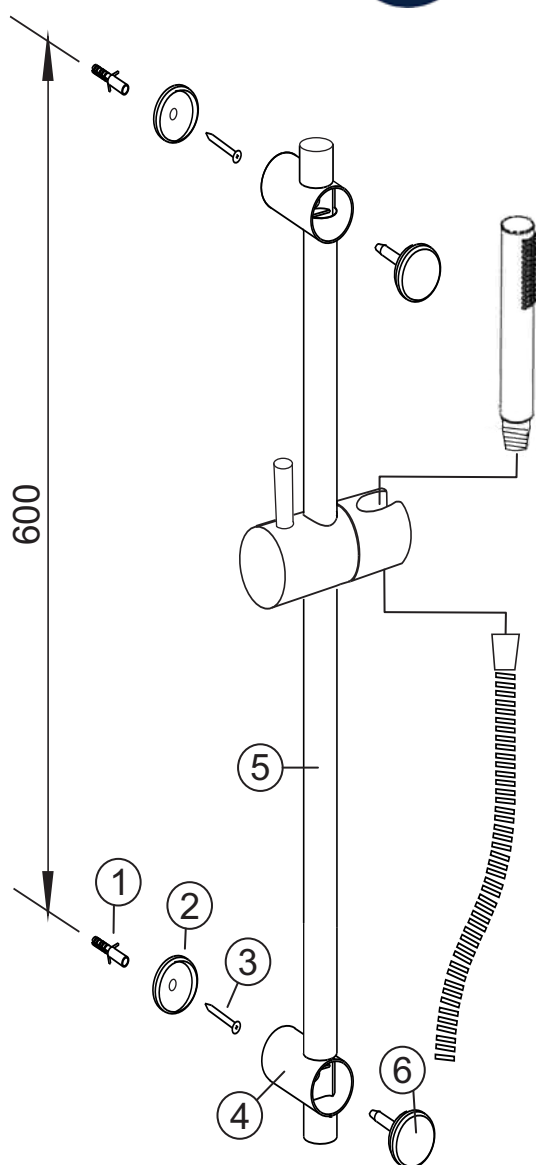

Installation Instructions

1. Mark the required position of the rail on the wall.
2. Drill 2 holes in the wall 600mm apart, and insert wall plugs (1).
3. Unscrew the wall flanges (2) from the rail-supports (4), and fasten to the wall using a screw (3) and into the wall plugs (1).
4. Carefully remove (unscrew) the support-caps (6), and take the rail-supports (4) off the rail (5).
5. Screw the rail-supports (4) onto the flanges (2) on the wall.
6. Align the holes, slide the rail (5) back into the rail-supports (4), and refit the support-caps (6). Hand-tighten only.

CLEANING RECOMMENDATIONS

We recommend the use of soapy water or mild detergents.
This product should not be cleaned with abrasive materials.
Damage caused by any improper treatment is not covered by the product warranty.
Refer to Warranty Conditions on www.johnsonsuiss.com.au

All dimensions are in millimetres and are subject to normal manufacturing variation.
As product development is ongoing BPA reserves the right to vary specifications without notice.