

## Notice d'installation

STICK SHOWER

### Outils

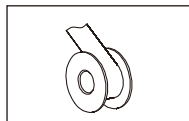
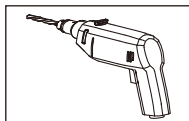
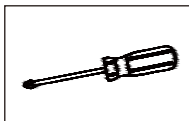
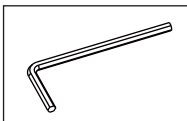
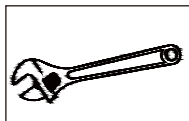

### Étapes d'installation

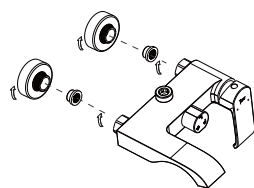
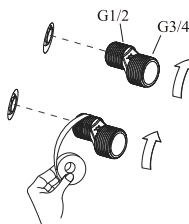
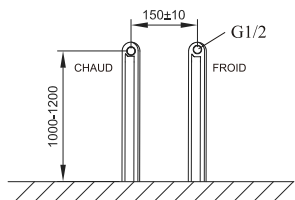

1

2

3

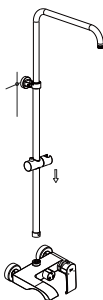
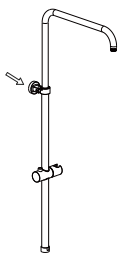

4

5

6

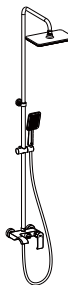
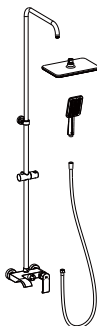
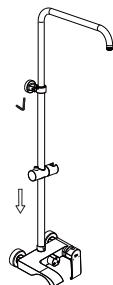

7

8

9

## Méthode d'utilisation

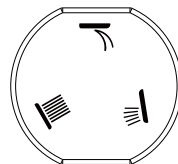
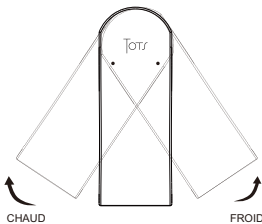
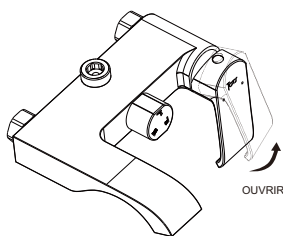

## Conditions d'utilisation

1. Pression d'alimentation en eau froide/eau chaude : 0,05-1,0Mpa (0,5-10Kg/cm).
2. La température ambiante doit être supérieure à 0°C.
3. Température d'alimentation en eau  $\leq 90^{\circ}\text{C}$ .
4. Le couple au niveau de l'écrou de connexion ne peut pas être supérieur à 10 Nm

TOTS Design decline toute responsabilité en cas de non-respect de ces instructions.  
Any failure to follow these instructions releases TOTS Design from any liability